



# Silver Cloud Hotel Broadway

1100 BROADWAY | SEATTLE, 98122

206.325.1400

## AMENITIES

Onsite Parking \$38+tax  
Courtesy Shuttle Service  
Wireless Internet  
Fitness Center  
Gift Shop  
Business Center  
Laundry Facilities

## GUESTROOMS

Seattle's Best Coffee®  
Aveda Bath Products  
Microwave  
Compact Refrigerator  
Secure Laptop Safe  
55" Flat Screen Television  
Dry Cleaning Services  
Hair Dryer

## RESTAURANT

Jimmy's on Broadway  
M-F 6am to 11pm  
S-S 7am to 11pm

## POLICIES

100% Nonsmoking  
48 Hr. Cancellation  
Must be 21 or Older  
Pet Free Hotel

[SILVERCLOUD.COM/SEATTLEBROADWAY](http://SILVERCLOUD.COM/SEATTLEBROADWAY)

# The Neighborhood

## EXPERIENCE

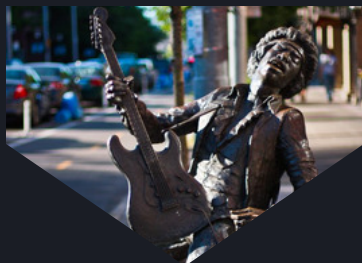

Dick's Drive-In!  
Cupcake Royale  
Station 7

Casita International  
Frye Art Museum  
NW Film Forum  
Full Tilt Ice Cream  
Stumptown Coffee  
Elliott Bay Book Co.

## EXPLORE



Cal Anderson Park  
Volunteer Park  
Pike Place Market  
Westlake Center  
Paramount Theater  
5th Avenue Theater  
The Great Wheel  
Seattle Center

## EXCITE



Garage  
Optimism  
Q Nightclub  
Rock Box  
Century Ballroom  
Neumos  
Chop Suey  
Neighbors  
The Cuff

## ENRICH



Seattle University  
Swedish Hospital  
Virginia Mason  
Harborview  
Seattle Central College  
UW







# Meetings & Events

## AMENITIES

Complimentary Wireless Internet

Tables & Chairs

Hotel Linens & Napkins

Complimentary Onsite Parking

Audio Visual Equipment Rental

## CATERING

Catering Services Offered through

Jimmy's on Broadway Restaurant

## CURRENT MENUS

## SPECIFICATIONS

Madison Room 785 sq. ft.

Broadway Room 1,015 sq. ft.

Madison & Broadway 1,800 sq. ft.

Executive Boardroom 280 sq. ft.



---

CONTACT SALES

[SALES@BROADWAY.SILVERCLOUD.COM](mailto:SALES@BROADWAY.SILVERCLOUD.COM)

206.325.1400

# Meetings & Events

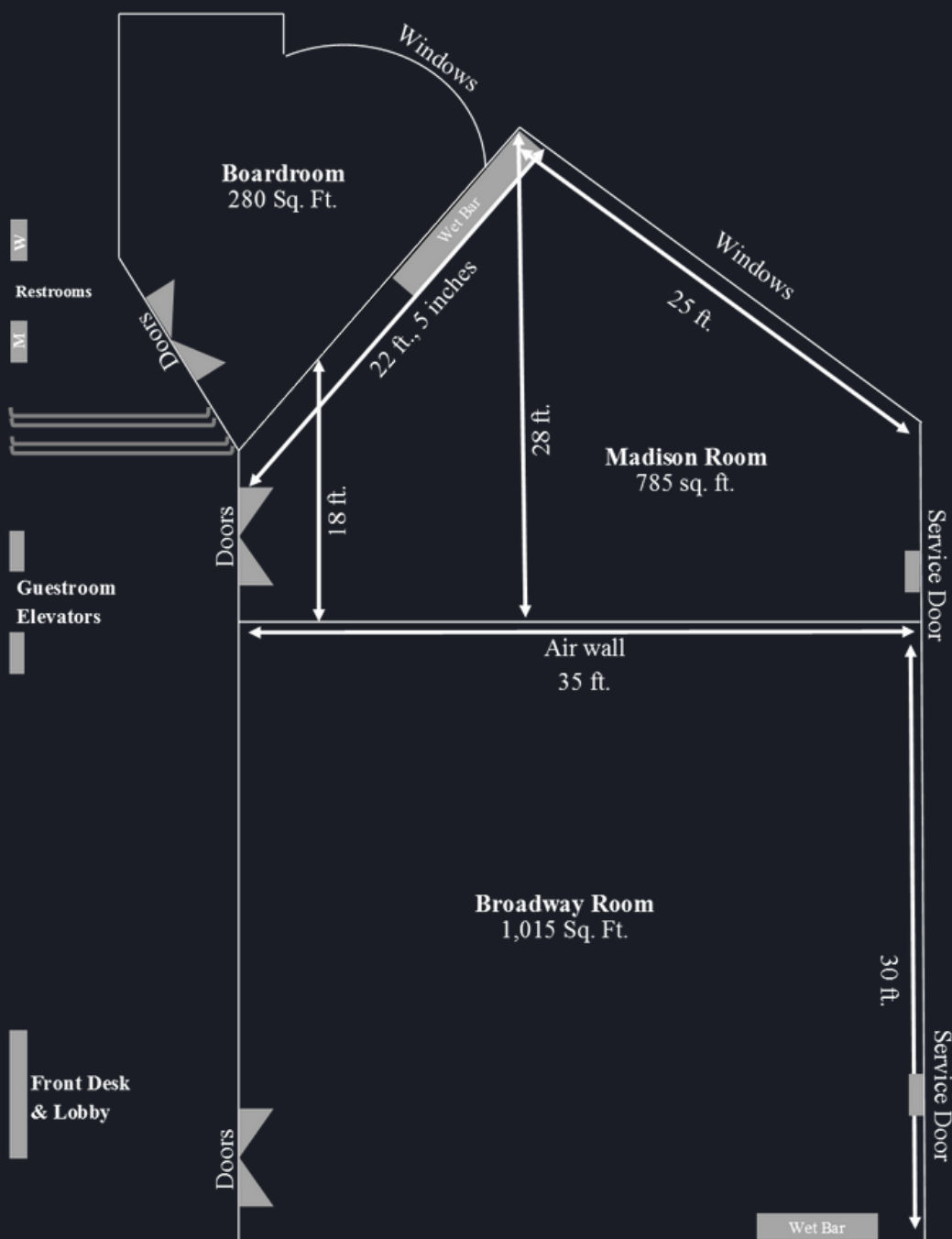

## CAPACITIES



EVENT SPACE	CLASSROOM	THEATRE	U-SHAPE	ROUNDS	RECEPTION
Madison Room	36	48	24	40	30
Broadway Room	48	80	36	60	50
Madison & Broadway	96	140	60	100	150

# Audio Visual Menu

## BOARDROOM PKG \$95

Flat Screen Television

HDMI Cable

Wireless Internet Connection

Whiteboard & Markers

## SILVER SCREEN PKG \$275

LCD Projector

AV Screen

PowerPoint Remote

AV Cart

Wireless Internet Connection

Power Strip

Extension Cord

## SILVER SOUND PKG \$295

Podium

Set of Speakers & Stands

Stereo Mixer

Wireless Internet Connection

Handheld Wired Microphone

## SILVER STAR PKG \$495

Silver Screen & Silver Sound

Packages Combined

## À LA CARTE ITEMS

LCD Projector \$175

PowerPoint Remote \$35

AV Screen \$85

Conference Phone \$75

Webcam \$150

Sign Easel \$20

Whiteboard & Markers \$45

Flip Chart & Markers \$45

Additional Paper Pad \$30

Laptop Computer \$125

Laptop Speakers \$20

Set of Speakers \$120

Handheld Wired Microphone \$35

Wireless Microphone \$55

Lavalier Microphone \$125

VGA Cable \$25

HDMI Cable \$25

Power Strip \$10

Extension Cord \$15

Additional Items Available by Request

ALL PRICES ARE PER DAY RENTAL

ALL RENTALS SUBJECT TO SALES TAX & SERVICE CHARGE

CANCELLATIONS WITHIN 24 HRS. OF EVENT WILL BE CHARGED IN FULL  
ITEMS RENTED NOT RETURNED TO HOTEL WILL BE CHARGED ACCORDINGLY



# Jimmy's on Broadway

RESTAURANT & BAR

1100 BROADWAY | SEATTLE, 98122

206.204.1188

## SERVING

Breakfast

Lunch

Dinner

Weekend Brunch

## HOURS

M-F 6am to 11pm

S-S 7am to 11pm

## BAR

Happy Hour

3pm to 6pm

9pm to Close

## SEMI-PRIVATE

## DINING

Group Reservations

Available for up to 32

Advance Reservations

Required

JIMMYSONBROADWAY.COM

Jimmy's  
ON BROADWAY



# Directions

## FROM I-5 NORTHBOUND

Take the Madison Street exit, #164A

Turn left on Broadway

Silver Cloud Broadway is on right

## FROM I-5 SOUTHBOUND

Take James Street Exit, #165

At the 2nd light turn left on James

Go uphill and turn left onto Broadway

Silver Cloud Broadway is on right

## FROM I-90 WESTBOUND

Follow signs to I-5 North

Take the Madison Street Exit, #164A

Turn left on Broadway

Silver Cloud Broadway is on right

Arrive at Hotel

Take Right Turn Down into Parking Garage

Enter Elevator, Take to Lobby Level



# Shuttle Service

## SERVICE HOURS

Daily Hours 7:00 AM - 10:30 PM

No Service Available at 11:00 AM, 2:30 PM, 4:30 PM & 5:30 PM

## DESTINATIONS

Washington State Convention Center | Convention Place Tunnel

Westlake Center | Sephora Store (across from Westlake Center Entrance)

Pike Place Market | 1st & Pine (Cupcake Royale side of Street)

Local Hospitals | Swedish First Hill, Harborview and Virginia Mason

CenturyLink Stadium | 5th & Weller (Seahawks game days only)

Safeco Field | 6th & Royal Brougham (Mariners game days only)

## DEPARTURES

Shuttle departs on the hour and half hour of each hour

Please make reservations in advance with a Guest Services Agent at the Front Desk

Space is limited and passengers are loaded on a first reserved basis

Convene in Lobby 5 Minutes prior to departure time

## PICKUPS

Call 206.325.1400 for Shuttle pickups

The Hotel will quote you an estimated pickup time

Please be at designated pickup point 5 minutes prior to your pickup time,

as the shuttle is unable to wait





# Transportation

## GENERAL INFO

Smartphone Apps Uber & Lyft are rideshare programs available. These apps allow you to track your ride via GPS & pay by phone

## TOWN CAR

One Way Airport Transportation with Northwest Town Car at \$45 Flat Rate  
4am - 11pm Hours  
Request via Hotel Guest Services

## TAXIS

Yellow Cab | 206.622.6500  
Far West | 206.622.1717

## FIRST HILL STREET CAR

Hours  
M-S 5am to 1am  
Sundays 10am to 8pm  
[seattlestreetcar.org](http://seattlestreetcar.org)

## GROUP TRAVEL

Northwest Town Car  
503.702.5999 | [northwesttowncar.com](http://northwesttowncar.com)  
Shuttle Express  
425.891.7000 | [shuttleexpress.com](http://shuttleexpress.com)  
Bellair Charters  
800.422.4042 | [airporter.com/bellair](http://airporter.com/bellair)

## LINK LIGHT RAIL

Hours  
M-S 5am to 1am  
Sundays 6am to 12am  
[soundtransit.org](http://soundtransit.org)

Guests may take the Light Rail from SeaTac Airport to Westlake Tunnel Station located at 4th and Pine Street. Call for Hotel Shuttle at 206.325.1400 for Westlake Center Pickup Location



# Silver Rewards

## PROGRAM BENEFITS

Complimentary Room Night | 2,000 Points

Complimentary Premium Room Night | 4,000 Points

Special Event Complimentary Room Night | 4,000 Points

Special Event Complimentary Premium Room Night | 6,000 Points

3,000 Alaska Airline Miles | 3,000 Points

\$100 Cash Reward | 3,000 Points

\$250 Cash Reward | 7,000 Points

\$100 Amazon Gift Card | 3,000 Points

\$250 Amazon Gift Card | 7,000 Points

\$100 Charity Donation | 2,500 Points

## HOW TO JOIN

Enroll Online at [silverrewards.com](https://silverrewards.com)

Click on the "Sign Up Now" Button

Agree to Terms & Conditions

Complete Information

Click "Join the Silver Rewards Program"



## INSTANT REWARDS

If you have enough Points at Check-In to Qualify for a Complimentary Room Night, our Agents will Process your Reward Instantly!

## EARN POINTS

Earn 1 Point for Every Guestroom Rental Dollar Spent (not including taxes)

## POLICIES

Only Individuals are Eligible for Silver Rewards Membership

Points may be Earned Retroactively for a stay up to 30 Days Prior to Enrollment

Wholesale Rates not Eligible for Points



# Brand Hotels

EVERY LOCATION IS A DESTINATION



## COMING SOON! - POINT RUSTON

5125 Grand Loop | 206.204.1183  
INTRODUCING A BRAND NEW  
RESTAURANT & SPA



## BROADWAY - SEATTLE

1100 Broadway | 206.325.1400  
FEATURING  
JIMMY'S ON BROADWAY RESTAURANT



Jimmy's  
ON BROADWAY



## STADIUM - SEATTLE

1046 1st Ave S | 206.204.9800  
FEATURING  
JIMMY'S ON FIRST RESTAURANT



Jimmy's  
ON FIRST



## UNIVERSITY - SEATTLE

5036 25th Ave NE | 206.526.5200  
FEATURING  
AG47 BAR & BISTRO



Ag<sup>47</sup>  
BAR & BISTRO



## EASTGATE - BELLEVUE

14632 SE Eastgate Way | 425.957.9100  
FEATURING  
NINE O BAR & GRILL



Nine O  
BAR & GRILL



# Brand Hotels

EVERY LOCATION IS A DESTINATION



## LAKE UNION - SEATTLE

1150 Fairview Ave N | 206.447.9500



## DOWNTOWN BELLEVUE

10621 NE 12th St | 425.637.7000



## REDMOND CENTER

2122 152nd Ave NE | 425.746.8200



## MUKILTEO WATERFRONT

718 Front St | 425.423.8600



## TACOMA WATERFRONT

2317 N Ruston Way | 253.272.1300

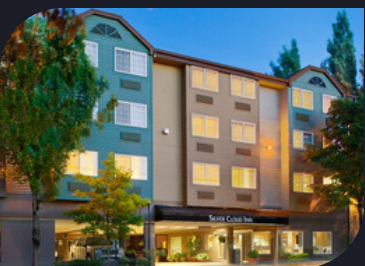

## DOWNTOWN PORTLAND

2426 NW Vaughn St | 503.242.2400

